



Since : 2000

SRP CRANE CONTROLS (INDIA) PVT. LTD.

Industrial crane & control Equipments

WIRELESS RADIO

REMOTE CONTROL FOR EOT CRANE



MODELS : 6+2 (Single Speed & Double Speed Both Available.)
10+2

www.srpcraneccontrols.in
info@srpcranecontrols.com



MADE IN INDIA
BE VOCAL FOR LOCAL
SINCE 2000

FEATURES

1. 100% in house production.
2. Any time repairable(because of PCB is made by us.)
3. 1 Year Mfg. Warranty.
4. 50 mtr. to 2000 mtr. range available.
5. waterproof ip65 and unbreakable.
6. you can also operate 2 or more crane from 1 remote(transmitter).
7. preplanned drop and pick up.
8. any kind of modification available as per your requirements.

9. 1 remote 2 or more crane.

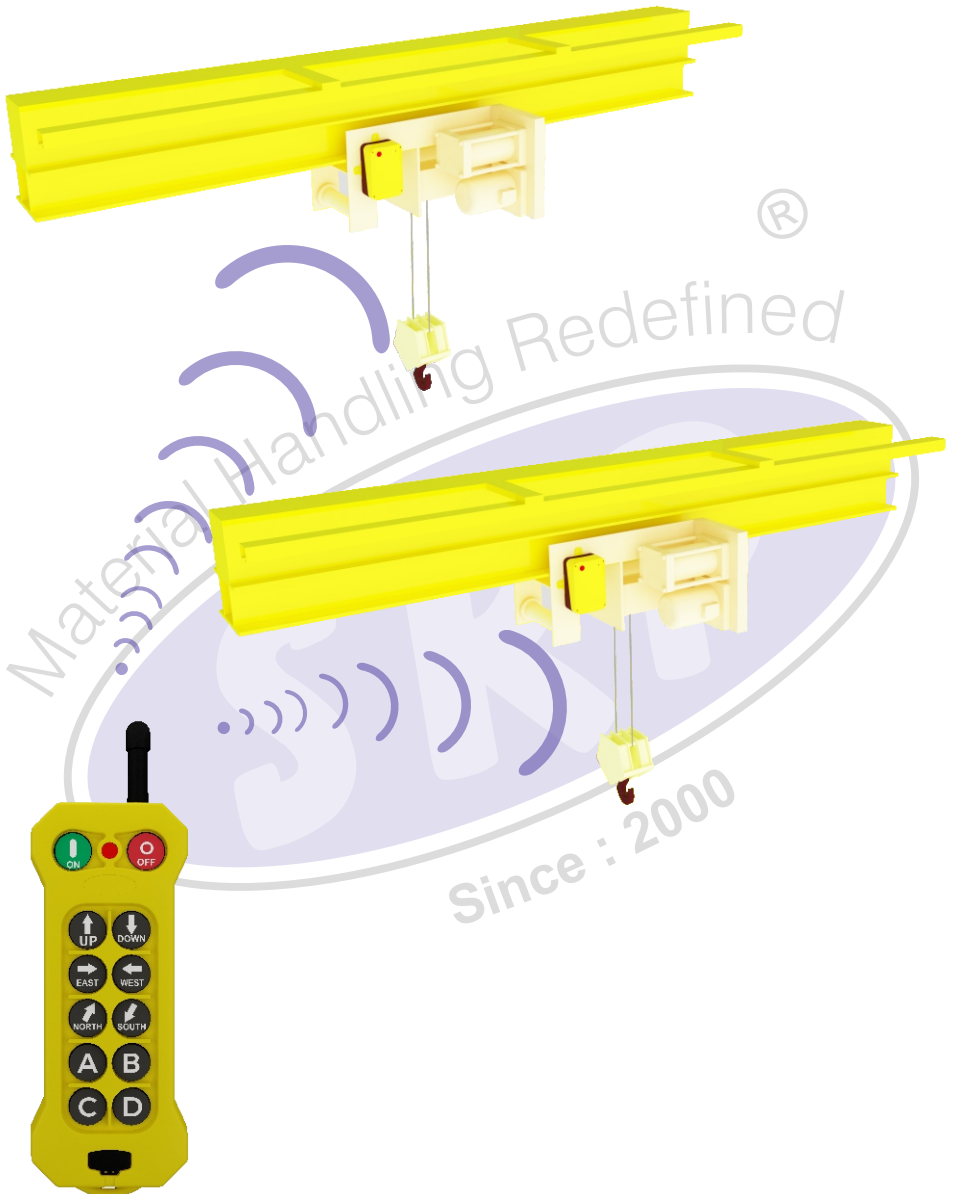

10. Preplanned pick up and drop. (preplanned fix position of crane at various place)

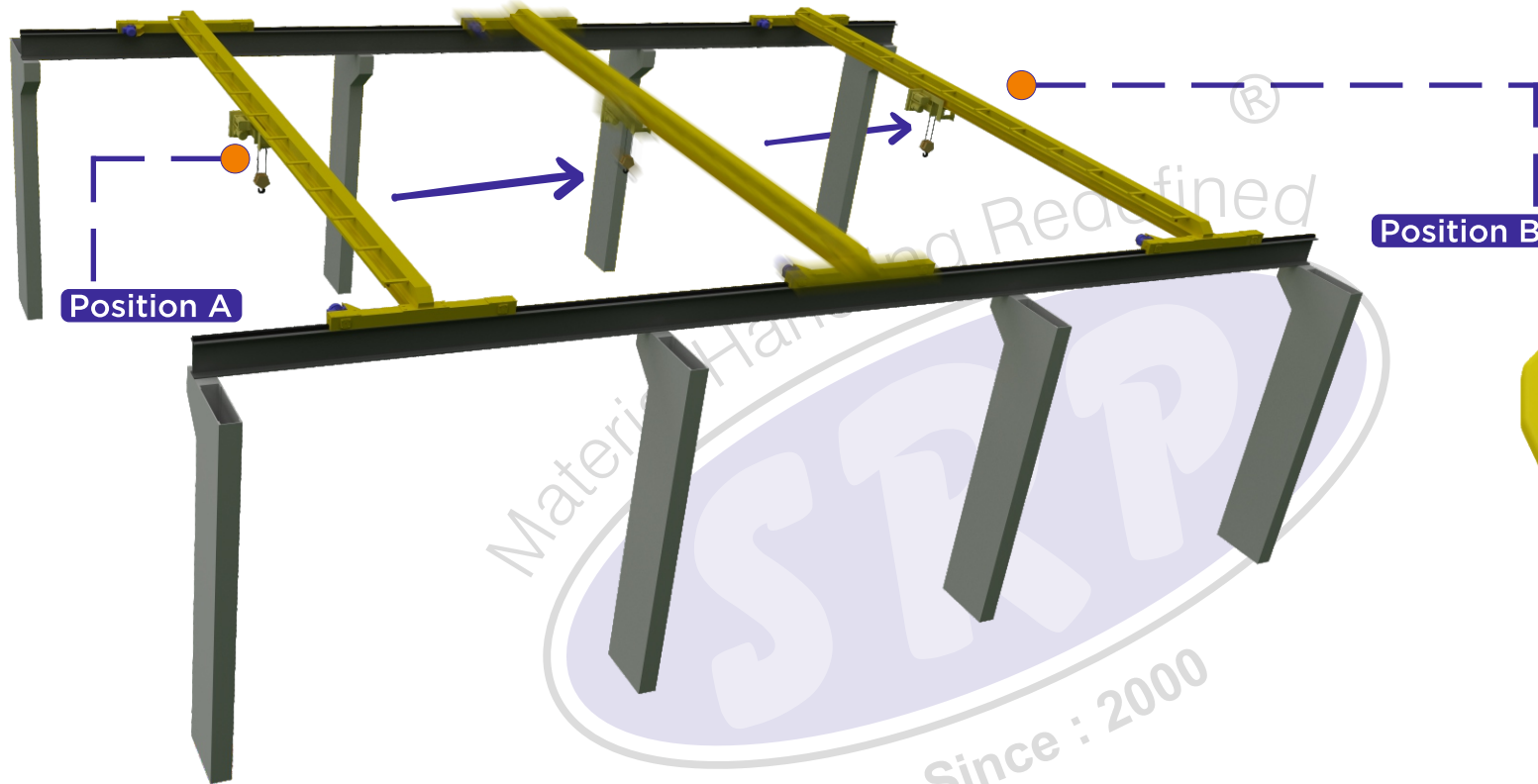

- PRESS button A to get the crane automatically at **Position A**
- PRESS button B to get the crane automatically at **Position B**



AA Battery Fitting DIAGRAM



Material Handling
Refined
000

Mounting DIAGRAM

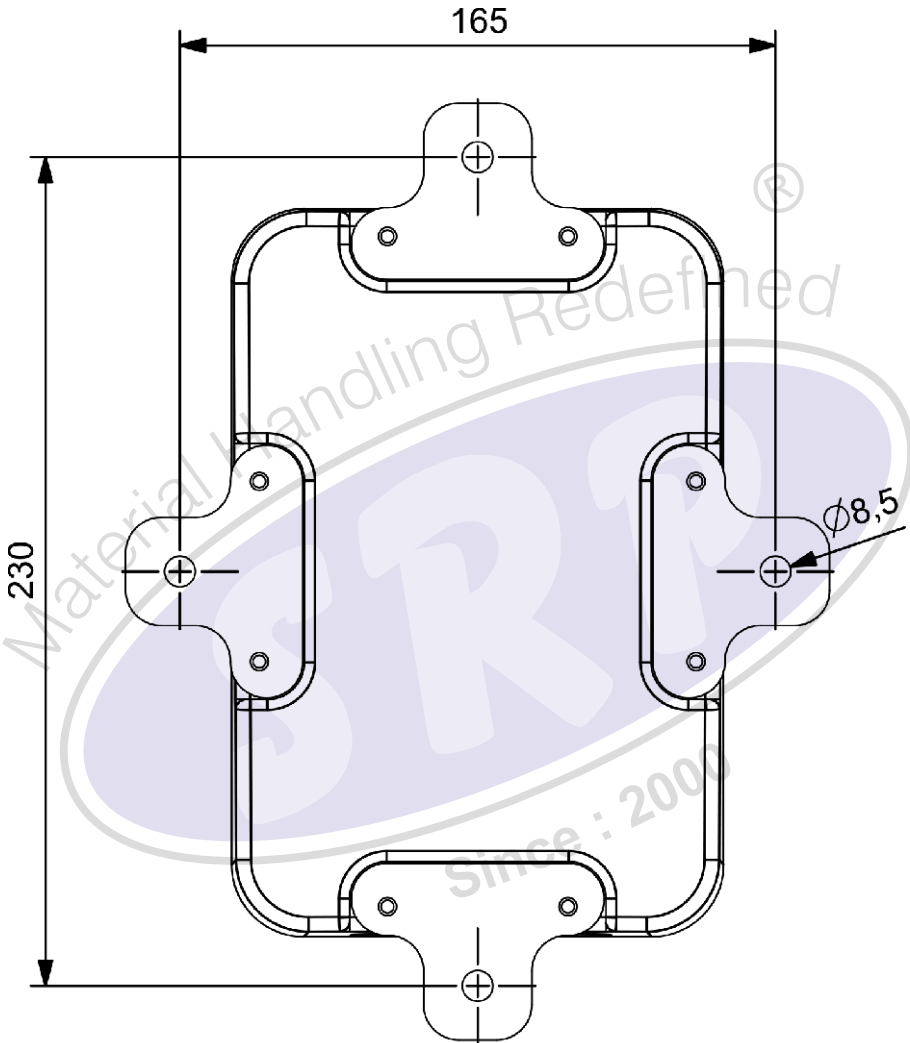

Remote Operation



INSTRUCTION MANUAL

1. Warranty



Warranty

- SRP Crane Controls (India) Pvt. Ltd. guarantees that this product meets its published specification at the time of shipment from the factory. Under proper installation it should work as expected.

Warranty Period

- This equipment is having warranty against defects in material and manufacturing for a period of one year from the date of shipment. During the warranty period, SRP CRANE CONTROLS (INDIA) PVT.LTD. is responsible for necessary repair as long as the product can be proven to be defective.
- For warranty service or repair this product must be returned to a service facility designated by SRP CRANE CONTROLS (INDIA) PVT.LTD. **Buyer will pay shipping charges** to SRP CRANE CONTROLS (INDIA) PVT.LTD. while SRP CRANE CONTROLS (INDIA) PVT.LTD. **will pay return shipping charges.**



Handling Redefined[®]



since : 2000

Excluded Items

- This warranty does not include consumable parts such as batteries, fuses, buttons, relays, Also this warranty does not cover defects caused by improper installation, improper or insufficient maintenance, unauthorized modification, improper operation, ignorance of environment specifications.

Remarks

- No other warranty is expressed or implied, except for the above mentioned.
- The remedies provided herein are the buyer's sole and exclusive remedies. SRP CRANE CONTROLS (INDIA) PVT.LTD.shall not be liable for any direct, indirect, special, incidental or consequential damages.

Since : 2000

2. Attention & Precaution

Attention

- Never dismantle the equipment by any unauthorized personnel, or it may be damaged.
- After finishing operation of radio remote control. Shut off main power to the crane, power to receiver, and remove transmitter key.

Precaution

- To avoid any interference, the Receiver must be away from motors, frequency converter and power cable as far as possible.
- The receiver should be installed on the top of the electrical control box. Don't mount the receiver inside the electrical control box.
- There are **4.3 billion ID Codes** for each complete unit with an unique one prior to shipment. To avoid any interference, please manage the remote controls with the different ID codes at a working site when installing.
- It is not allowed to use the same series models with the same frequency in the **range of 100 meters**.

Procedures of emergency

- In case of an Emergency, please follow the steps below and ask a distributor for service immediately.
1. Press STOP.
 2. Pull out the key.
 3. Switch off the machine being controlled.
 4. Contact the dealer for help to find the cause.



3. Installation & Operation

General Operation

- Remove the cover of battery box.
- Install Fresh AA-size **alkaline** batteries (recommended:- Duracell) in the battery box. Make sure the “+” and “-” direction are correct.
- Press the START Switch.
Note : LED indicator will not flash if proper procedures are not followed.
- Operate transmitter by pressing each pushbutton.
- After operation, perform the following procedures in sequence:
 1. Press STOP Switch.
 2. Remove key and keep it in a safe place
 3. Remove batteries if not used for a long period.

Transmitter Batteries

- The AA size alkaline batteries are required for the transmitter. DO NOT use rechargeable batteries. **The LED will flash green when the battery power is sufficient.** The LED will flash red when the battery power is low, and it is required to replace with fresh batteries immediately.

Receiver Power Supply

- There are two type of receiver relays board for DC and AC power supply.
 - A.The voltage for the DC power supply is 12VDC.
 - B.There are four different transformers with different voltages for the AC power supply containing AC 24, 48, **110**, and 220.

LED Malfunction Alert

- TX green LED is flashing quickly when any function pushbutton is pressed, then the problem could be:
 - A : The system is not properly powered on according to the instructions.

NOTE: If a problem on the above is found, please contact the distributor for repair.

Since : 2000

3. Safety Instruction

- Do not subject the transmitter to impacts or shocks as it could be damaged. **Replace the batteries when the voltage is low.** Avoid impacts, shocks and throws.
- Never open the case if you do not have the technical authorization to do so. It could damage components and cause personal injury.
- Do not test the button blind; it could involve serious safety risks.
- Do not use the system during thunder storms or powerful interference.
- After use, switch off the power supply to the receiver and remove the emergency key.
- Prevent other signals interfering by placing the receiver at a distance from transformers, motors and umbilical cables.
- The receiver cannot be installed in the distribution box. It should be installed over or on a suitable location outside the distribution box.
- The remote control for industrial use several ID codes set at the factory. If two or more units are used in the same area different ID codes must be selected.

4. Troubleshooting

- If the RX does not respond at all, please turn off the power supply for 20 seconds and then turn it on again to the receiver.
- If the range shrinks, or the receiver works irregularly, it could be due to low battery level, replace the batteries.
- Other common problem and solutions.

Problem	Possible cause	Action
Command button doesn't respond	1. Poor contact with terminals	Tighten the screws
	2. Damaged AC contact	Replace AC contact
	3. poor contact with connector receiver	Open the receiver case, lift up the connector and replace it
The response is irregular and the range is shrinking	1. Weak power supply to the transmitter	Check the transmitter's indicator lamp and replace the batteries if the lamp is shining weakly
	2. Interference	Make sure no other radio control unit within 100 m is using the same channel
	3. Incorrect placement of receiver	The receiver must not be placed inside a metal casing and it should be placed at least 0.5m from any generator or transformer
	4. Damaged high frequency unit	Contact authorized technicians or local representative
No complete response	1. Weak power supply or damaged transmitter	Replace batteries or transmitter
	2. Weak power supply to the receiver	Check circuits and power supply
	3. The power supply doesn't correspond to the given voltage for the receiver	Check the label on the receiver and select a supply with the correct voltage
	4. Damaged fuse in the receiver	Open the receiver case and replace fuse
	5. Receiver damaged due to incorrect connection	Contact authorized technicians or local representative

**if none of the above actions rectify the problem, contact the dealer or distributor.*

Technical specification Of Remote control

Operating frequency	422 - 440 MHz
Range	50m to 2000m in open field
Operating voltage transmitter	2 pcs AA batteries
Outgoing interface	Relays 10 A
Received direction	Non - directional
Operating temperature	-20 °C to +85 °C
Enclosure class	Ip65
ID Code	Over 1 Million Sets
Channel Space	100 KHz
Structure	Enhanced glass-fiber
Operating voltage receiver	24, 110 , 220 VAC DC
Number of commands	Push Button + START/STOP + Alarm
Standby Power Consumption	<1 mA
Response Time	<24ms
Active Emergency Response Time	<24ms
Total Approx Weight	700 gm
Dimensions(6+2 model)	174mm (H) x 44.5mm (W) x 74mm(B)
Dimensions(Reciever)	200mm (H) x 89mm (W) x 136mm (B)



Material Handling Redefined®



Since : 2000

SRP CRANE CONTROLS (INDIA) PVT. LTD.

Survey No: 202, Jaydev Industrial Estate,
Plot No:39, Opp.Essen Road,N.H.27,
Village:Veraval(shapar),Ta. Kotda Sangani,
Dist : Rajkot 360024 Gujarat,India.

www.srpcranecontrols.in
info@srpcranecontrols.com
